



*It's our turn to  
create the future!!*

# GBC

## KOBE JAPAN



UNIVERSITY OF HYOGO

Global Business Course  
School of Economics and Management





## About Hyogo Prefecture

Hyogo Prefecture is located in the geographical center of Japan,  
and is easily accessible to the world by sea and air.

After the opening of the Port of Kobe in 1868,  
Hyogo was among the earliest in Japan to embrace culture and people  
from foreign countries.

As a result, Hyogo Prefecture has played  
a leading role in Japan's globalization.

Furthermore, Hyogo Prefecture has great diversity through its five regions,  
Settsu, Harima, Tajima, Tamba, and Awaji,  
and thus, it is referred to as a "Microcosm of Japan".

## About Kobe City

Kobe is the capital city of Hyogo Prefecture  
and was one of the first Japanese cities to open  
for trade with foreign countries.

With its unique background, Kobe has innumerable attractions.  
It has the wonderful seafront along the Seto Inland Sea  
and beautiful, expansive views from the top  
of Mt. Rokko, as well as many more places  
to see and experience.

Kobe remains a cosmopolitan city  
that is home to well-known global enterprises such as  
Kawasaki Heavy Industries, Kobe Steel, and ASICS.





## About the University of Hyogo, Kobe Campus for Commerce

The Kobe Campus for Commerce is located in western Kobe,  
in a special educational district of the city.

The campus is the home of the Global Business Course  
as well as the School of Economics and Management.

It is a calm, idyllic setting for studying,  
with easy access to central Kobe,  
including Kobe Airport and shinkansen (bullet train) station.



# Welcome!

## University of Hyogo Prepares for You for Future Careers in the Global Arena



### Makoto Kosaka

President of The University of Hyogo



With a history of nearly 100 years, the University of Hyogo is now one of the leading public universities in Japan, with six faculties, nine graduate schools, and five research institutes.

The University promotes innovative, interdisciplinary education and research activities based on the concepts of "well-being" and "leave no one behind," as stated in the SDGs. Drawing a cutting-edge technology, including digital intelligence such as generative AI and online international collaborative programs, we provide education that enables students to acquire both critical and creative thinking.

We hope you will grow through your studies and become professionals of "knowledge" who can lead global society in the right direction and build bridges rather than walls between people.

Each of you is a hero and a hope for an affluent, diverse future society. Please come to Kobe and become a member of the GBC community. We look forward to seeing you and supporting you.

## Academics

### Overview

The Global Business Course (GBC) was established in the School of Economics and Management in 2019 and is located in the Kobe Campus for Commerce. The GBC is the first program taught only in English at the University of Hyogo. Each year, about 30 international students and 50 Japanese students are enrolled in the program.

### What We Offer

In the GBC, students learn together in a multicultural environment. They participate in unique cross-cultural experiences not only by studying in GBC but also by living and communicating with each other in Global House, the international dormitory, as well as in the Center for Global Engagement.

All students study in seminars throughout their 4 years in addition to their other classes. All of the seminars have a small number of students, which is ideal for exchanging ideas and thoughts with classmates and professors.

### Study Japanese and Experience Japan

GBC international students take Japanese language classes as well as classes to learn about and experience Japan. They begin with intensive language courses suitable to their level of Japanese, from beginner to advanced, in order to make their new lives in Japan easier. After this, they continue the systematic study of Japanese as well as take classes to increase their understanding of Japanese culture and Japanese Economics and Management practices.

### Economics and Management

One of the unique strengths of the GBC is that its curriculum provides students with opportunities to study both economics and management from the basics to advanced levels in English. Through studying theories of economics and management, GBC students learn how to put theories into practice and how to make decisions based on these theories.

In addition, there are exciting fieldwork and internship opportunities. The University of Hyogo enjoys unique connections with major enterprises located in Kobe and elsewhere in Hyogo Prefecture, and such connections allow GBC students to join internship programs and have opportunities for actual experience to deepen their understanding of Japanese enterprises.



# GBC's Mission : Develop

## Student's Voice

In the Global Business Course, you earn the Degree of Bachelor of Economics with a Practical Specialization

**4th  
year**

### Advanced Subjects

- Graduation Research, Thesis, and others.

**Graduate School of  
Social Sciences  
the Degree of Master of  
Global Business  
Administration**

**3rd  
year**

### Advanced Subjects

- Public Economics, Economic Development
- Entrepreneur Studies, and others.

**Field  
Study  
Program**

**2nd  
year**

### Intermediate Subjects

- Macroeconomics, Microeconomics
- Strategic Management, International Marketing
- Intercultural Communication, and others.

**1st  
year**

### Liberal Arts and Introductory Subjects

- Japanese, Japanese Culture and Society
- Life Science, Regional Affairs, Safety Management
- The Basics of Economics and Management, and others.



**Solongo Batzaya**

from Mongolia, enrolled in 2021

Being part of GBC has been a truly exceptional choice in my life. The uniqueness of our community lies in the profound connectivity and close-knit relationships fostered among students, and in being perpetually engaged in mutual learning. Our classes are delivered by esteemed professors in English. Moreover, the comprehensive range of Japanese language courses for international students, combined with the opportunity to interact with native speakers, has academically elevated my proficiency. Our campus provides an ideal environment for scholarly pursuits, comprising a well-appointed library, a delectable and health-conscious cafeteria, and a newly-built, secure dormitory replete with numerous advantages. Supported by caring dorm managers and resident assistants, dorm life is both comfortable and nurturing. The affable university staff, professors, dorm managers, and fellow students create a friendly atmosphere, making our university an optimal setting for a successful and memorable academic journey.



**Nguyen Pham Minh Quang**

from Vietnam, enrolled in 2022

Having the opportunity to study at GBC has brought me a great deal of useful experiences during my first year.

In my study, I enjoyed the open academic environment, which is helpful for students to exchange ideas and receive constructive feedback. The subjects are diverse and crucial to gain economic knowledge and deepen social understanding. I also love the thoughtfully-organised field trips with hands-on experiences to discover Japanese culture.

In my student life, extracurricular activities such as playing basketball at the gymnasium are wonderful to be reenergized after the lectures. Furthermore, living at the Global House is not only convenient, but also facilitates connections with friends from various countries.

I strongly believe that studying at GBC is significant to fulfill my dreams and future career.





# Raising Global Leaders

## Global House

### International Domitory

All GBC students are required to live in the on-campus, international dormitory, the Global House, for their first year. Three or four students share the same unit, which includes a kitchen, living room, and bathroom. However, each student has their own bedroom where they can enjoy privacy.

Students who become Resident Assistants (RA) live in Global House in their second year, as well. RAs act as leaders in the dormitory, support the new students, and create a comfortable environment in which everyone can study and socialize as they wish.

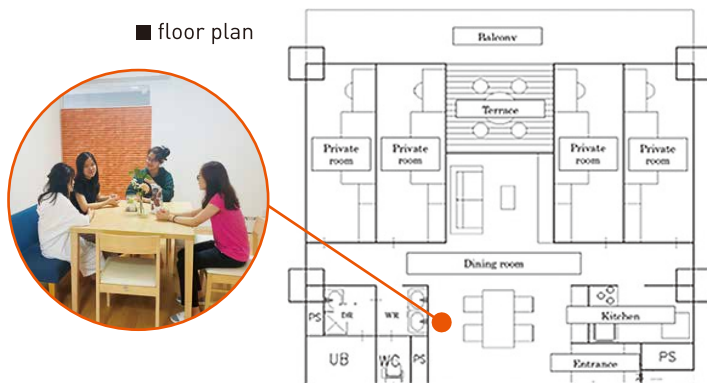

### Housing

The University of Hyogo provides GBC students with support in looking for housing when it is time for them to move out of Global House.

# Key Facts

## - Tuition Fees and Exemptions exclusively for International “Global Business Course” Students

\* Fees are subject to change without notice (JP Yen)

Year	Student Classification	Fee	Exemptions	Amount to be Paid
1st Year	All students	535,800	267,900	267,900
Each of 2nd–4th Years	Top 30% of Year	535,800	535,800	0
	Other students		267,900	267,900
Total for 4 Years	Always top 30% of Year	2,143,200	1,875,300	267,900
	Always other students		1,071,600	1,071,600

## - Application and Admission Fees

\* Fees are subject to change without notice  
\* Other extra expenses such as Education Enhancement Fee and Student Council Fee are required to pay. (JP Yen)

Items	Student Classification	Fee	Exemptions	Amount to be Paid
Application Fee	All students	17,000	8,500	8,500
Admission Fee	All students	282,000	141,000	141,000

## - Living Expenses

\* Dormitory rent is subject to change without notice (JP Yen)

		Amount per month
Rent	All 1st Year GBC students are required to live in the International Dormitory “Global House”.	30,000~50,000 *Rent of “Global House” is 30,000
Other living expenses	e.g.meals, clothes, books	75,000 (Approximately)

## - Other Possible Financial Aid

Japanese Government Scholarship (MEXT Scholarship)
Private and Public Scholarships offered by various organizations

The contents, details, and cost of the GBC are subject to change.  
Please check our website for the latest information.

## After Graduation

GBC students come from a wide range of backgrounds. Upon graduation from the GBC, students will be prepared to pursue many different opportunities. The Career Center can assist students in finding paths that are right each of them.

GBC students have a chance to experience internships in major Japanese companies, whose headquarters are located in Hyogo Prefecture. Furthermore, there is a chance to enroll in the GBC Graduate School in order to further deepen their knowledge of economics and management.



# Life at the University of Hyogo

## Financial Aids/Exemptions/Scholarships

All international GBC students are granted a 50% reduction in tuition for 4 years. Also, from the second year until the 4th year, students with grades in the top 30% are exempted from paying tuition.

In addition, the University of Hyogo offers other forms of financial aid. Thanks to the generosity of donors, international GBC students are entitled to receive startup aid in their first year. Other scholarships include JASSO and private scholarships exclusively for international students.

## Counseling

If students have any concerns about their physical, mental, or emotional health or well-being, there is a healthcare center on campus, where students have access to counseling in English on a regular basis.

## Club Activities

There are variety of club activities at the Kobe Campus for Commerce. Students can participate in clubs such as soccer, Japanese archery, dance, or music, or they can start their own. Also, every year in autumn, the University Festival, Shodaisai, is held.



# Global Business Course Admissions for International Students

## Quota for students from overseas

30 per year

## Application Eligibility

### ■ Requirement 1: Educational Qualifications

(1) Applicants **MUST** have completed, or are expected to complete, a 12-year standard education curriculum at an educational institution, equivalent to a Japanese 12-year official education curriculum.

\*Note that those who attended Japanese junior and/or senior high school for up to three years in total are eligible to apply.

(2) Those who are acknowledged to have completed, or are expected to complete, a curriculum equivalent to 12 years of Japanese education.

### ■ Requirement 2: English Proficiency

Applicants **MUST** achieve score on a standardized English proficiency exam that is equivalent to the B2 level of the CEFR (Common European Framework of Reference for Languages) or higher.

(Please refer to the latest Application Guidelines.)

## Screening Method

Students will be selected based on their application documents and an interview.

The interview will be conducted in English, either locally or through the Internet.

Applicants residing outside Japan do not need to come to Japan for the interview.

## Screening Schedule

(Please refer to the latest Application Guidelines.)

### • Application Guidelines

### • Application Forms

→ <https://www.u-hyogo.ac.jp/english/index.html>



**Come visit GBC** <https://www.u-hyogo.ac.jp/em/en/gbc/courses/index.html>

 YouTube



Introducing  
Global Business  
Course (GBC)



Introducing  
Global House



Follow our INSTAGRAM  
@gbc\_hyogo



兵庫県立大学  
UNIVERSITY OF HYOGO

UNIVERSITY OF HYOGO

8-2-1 Gakuennishi-machi Nishi-ku Kobe Hyogo / 651-2197 JAPAN  
[GBC Admissions Office] +81-78-794-5362